



OPERATION MANUAL
FOR
SODIR
HALF-SIZE CONVECTION OVENS

MODELS FC-60 & FC-60/1





INTRODUCTION

The SODIR models FC-60 and FC-60/1 convection ovens are designed to offer quality baking, cooking and rethermalization. The ovens are constructed of food service quality stainless steel and are equipped with rear-mounted blower fan and heating element. The units are thermostatically controlled up to 570 F and include a 120-minute timer. Two indicator lights – green and red – add convenience for operator. Standard units include four wire baking racks. Both models will accommodate up to four half size sheet pans or two-thirds size cafeteria pans.

SPECIFICATIONS

| Model | Electrical | Plug Configuration |
|--------------|----------------------------------|---------------------------|
| FC-60 | 208/240V, 1PH, 3KW 13/15 Amps | NEMA-6-20P |
| FC-60/1 | 120V, 1PH, 1.7KW 15 Amps | NEMA-5-15P |

INSTALLATION

The SODIR convection ovens need to be connected to a grounded outlet of proper voltage (208V, 240V or 120V) depending on the model. DO NOT place the unit in a damp area or near steam sources. Make sure that the exterior back cover is not blocked. Maintain 4" clearance at rear and, at least, 2" at each side and top of the oven.

ASSEMBLY

The SODIR convection oven comes from the factory assembled, but with the 4" legs and adjustable feet removed for shipping. The oven is shipped with the exterior protective film. DO NOT operate the oven prior to removing the protective film completely.

OPERATION

PREHEATING

To preheat the convection oven, select temperature by rotating the thermostat knob clockwise to desired temperature setting and then turn the timer knob that also acts as an ON/OFF switch clockwise to the maximum setting (120 minutes) or set timer at continuous position marked by a hand icon on the timer dial. Both indicator lights (green and red) will be lit. The red light will stay on until the oven reaches the desired temperature. The green light will stay on until the timer reaches the indicated time setting. Allow up to 18 minutes for the preheating process.

COOKING

After the preheating process is completed, select the desired cooking or baking temperature (unless it is already set) and turn the timer knob clockwise to select the time setting. The red light will stay on until the oven reaches the desired temperature. When the set time is elapsed, the heating element and the blower fan will be switched off and the green indicator light will go out. At the end of the cooking cycle, the timer produces repetitive buzzing signal until it is depressed.

The timer can be used in continuous mode. To do so, turn the timer counterclockwise from the **0** position (continuous mode position is depicted by a special hand-like marking on the timer dial).

The SODIR convection ovens can be used for a wide variety of foods. Cooking times will vary depending on food products, temperature settings and desired results.

COOLING DOWN

To cool the oven down, turn the regulating thermostat knob counterclockwise to any position between **0** and the first temperature position marked **200 F**. Turn the timer knob to select the appropriate time setting or to continuous mode. It is not necessary to keep the door partially open to operate the oven in its "cool down" mode.

CLEANING

WARNING: Disconnect (unplug) electrical power supply before cleaning or servicing

Cleaning is very important in maintaining a safe and well working machine. Allow the oven to cool before cleaning. Remove the baking wire racks and clean them separately using a damp cloth or sponge and mild cleaning liquid soap. Use a cloth dampened slightly with a soap and water mixture to clean all exterior and interior stainless steel surfaces and glass. Use a clean lint-free cloth to remove the excess water or soap.

DO NOT use abrasive sponge on exterior or interior surfaces

DO NOT wash oven under running water

DO NOT spray the exterior motor housing with any liquid

DO NOT allow water to drip into the motor housing or onto electrical component

OVEN DOOR REMOVAL

The SODIR Models FC-60 and FC-60/1 are equipped with a double glass door which is easily removable for cleaning. For cleaning, remove the door following the steps below:

- Open the door completely
- Move each hinge lock to "UP" position (one lock per hinge)
- Tilt the door up at 45 – 60 degree angle (hinge lever arm will be released)
- Pull the door out of the hinge slots

Upon removal, the door can be washed or cleaned both on the inside and the outside. To install the door, reverse the procedure. DO NOT leave the hinge lock in "UP" position at the end of installation.

MAINTENANCE

Inspect all parts on a regular basis to ensure that the parts are in good working order. If a part is damaged, have the unit repaired by an authorized service agency prior to returning the unit to operation. If you have trouble locating a service agency in your area, call **EQUIPEX, LTD.** at 1-800-649-7885 and ask for customer service.

FC 60

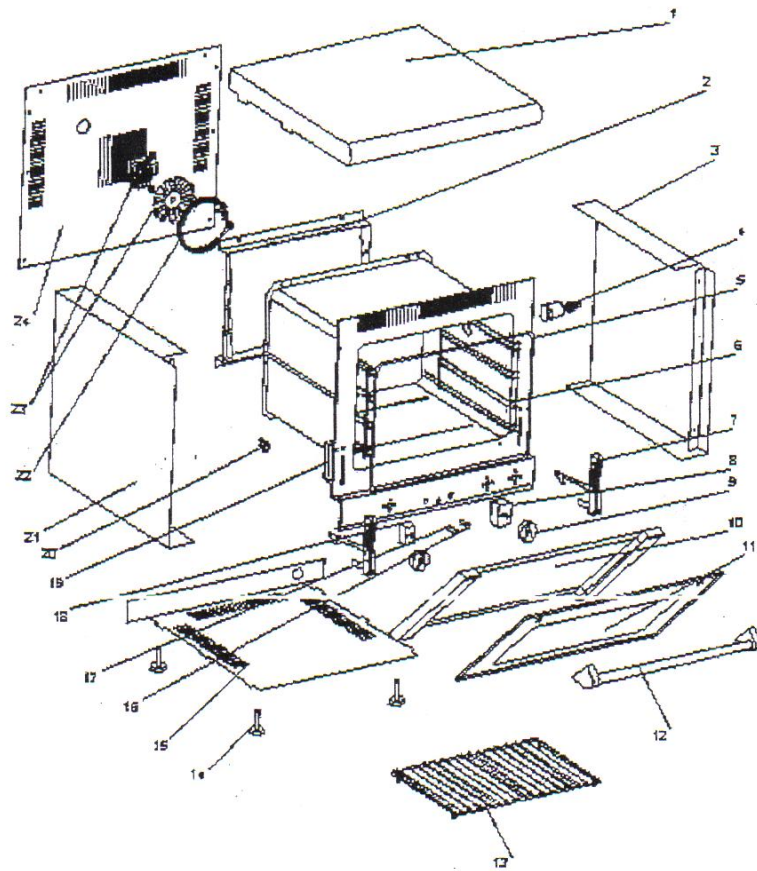

| EQUIPEX. LTD. | | | 29-Apr-02 | SPCONV-60-01 |
|-------------------------------------------------------|-------------|-----|-------------------------|-----------------|
| 765 Westminster Street, Providence, RI 02903 | | | | Effect.02/01/02 |
| tel: (401) 273-3300 fax: (401) 273-3328 | | | | |
| SODIR Model FC-60 (208/240V) and Model FC-60/1 (120V) | | | | |
| Drawing # | Part Number | Qty | Description | Old Part Number |
| 1 | 15124I308 | 1 | Oven Cover | n/a |
| 2 | 15111I108 | 1 | Ventilation Cover | n/a |
| 3 | 15016I308DR | 1 | Right enclosure | n/a |
| 4 | A18004 | 1 | Lamp with fixture | n/a |
| 5 | H03005 | 1 | Door Gasket | n/a |
| 6 | F01039 | 2 | Shelf Structure | n/a |
| 7 | B09005 | 2 | Door Hinge | n/a |
| 8 | A02014 | 1 | 120 min Timer w/buzzer | n/a |
| 9 | A14078 | 2 | Knob | n/a |
| 10 | H01012 | 1 | Interior Glass | n/a |
| 11 | H01011 | 1 | Exterior Glass | n/a |
| 12 | A15010 | 1 | Handle | n/a |
| 13 | F01035 | 4 | Wire Shelf | n/a |
| 14 | A13012 | 4 | Leg | n/a |
| 15 | 15017G010 | 1 | Bottom Enclosure | n/a |
| 16 | A08009 | 1 | Green Pilot Light, 220V | P-S108011 |
| 16 | A08007 | 1 | Green Pilot Light, 120V | P-S108011 |
| 17 | A08008 | 1 | Red Pilot Light, 220V | P-S108005 |
| 17 | A08002 | 1 | Red Pilot Light, 120V | P-S108005 |
| 18 | A06042 | 1 | Regulating Thermostat | P-S106003 |
| 19 | B09007 | 2 | Hinge Support | n/a |
| 20 | A06034 | 1 | High-Limit Thermostat | n/a |
| 21 | 15016I308GA | 1 | Left Enclosure | n/a |
| 22 | D02034 | 1 | Heating Element, 220V | n/a |
| 22 | D02090-60 | 1 | Heating Element, 120V | n/a |
| 23 | A03001 | 1 | Motor, 220V | n/a |
| 23 | A03003-60 | 1 | Motor, 120V | n/a |
| 24 | 15018G010 | 1 | Back Cover | n/a |